

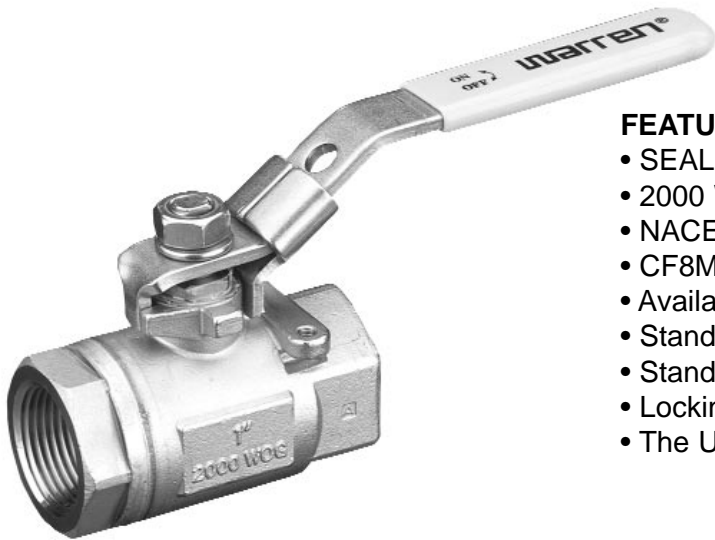

VALVES

Series W20 Seal Welded Ball Valves

1/4" - 2" 2000 WOG



FEATURES

- SEAL WELDED CONSTRUCTION
- 2000 WOG Rating on all sizes
- NACE MR-01-75 Compliant
- CF8M Bodies and Tailpieces, 316 Stainless Steel Internals
- Available in Male X Female Construction in 1/4"-1" Sizes
- Standard Actuator Mounting Pads on all sizes
- Standard Locking Stainless Steel Handles
- Locking Stainless Steel Oval Handles Available
- The Ultimate in Safe Design

MOUNTING HOLES
 1/4" - 1".....10-24 NC
 1" - 1/4"-2"..1/4-20 NC

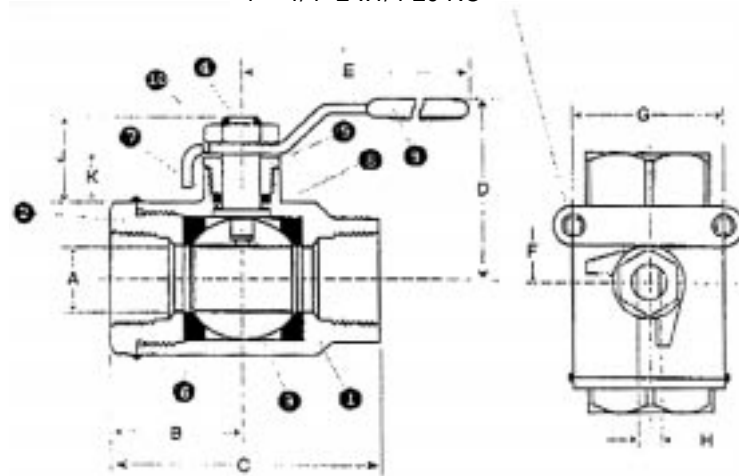

RATINGS

2000 PSIG @ 100F WATER, OIL, GAS
 150 PSIG SATURATED STEAM

MATERIALS OF CONSTRUCTION

PART	DESCRIPTION	STANDARD MATERIAL	OPTIONAL MATERIAL
1	BODY	ASTM A351 Gr.CF8M	ASTM A351 GR. CF8M
2	TAILPIECE	ASTM A351 Gr.CF8M	ASTM A351 GR. CF8M
3	BALL	ASTM A276 Gr.316	Alloy 20
4	STEM	ASTM A276 Gr.316	Alloy 20
5	PACKING NUT	ASTM A276 Gr.316	Alloy 20
6	SEATs (2)	R-PTFE	Steam Seats, PEEK
7	PACKING	R-PTFE	Graphite, PEEK
8	THRUST WASHER	R-PTFE	PEEK
9	HANDLE ASSY	Stainless Steel w/Vinyl	Stainless Locking Oval
10	HANDLE NUT	Stainless Steel	

R-PTFE SEATS

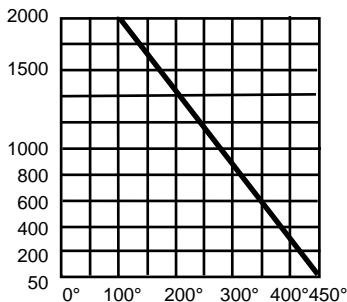

DIMENSIONS, WEIGHTS, CV FACTORS & MAXIMUM OPERATING TORQUE

SIZE	A	B	C	D	E	F	G	H	J	K	WEIGHT LBS.	Cv Value	MAX TORQUE
1/4-3/8"	0.38	1.10	2.20	1.80	4.40	0.50	1.12	0.20	0.86	0.50	0.50	9	40 IN-LB
1/2"	0.50	1.20	2.40	2.00	4.40	0.50	1.12	0.20	0.96	0.55	0.66	16	75 IN-LB
3/4"	0.69	1.40	2.80	2.40	5.90	0.87	1.38	0.28	1.32	0.71	1.32	27	120 IN-LB
1"	.87	1.60	3.20	2.60	5.90	0.87	1.38	0.28	1.31	0.70	1.81	42	140 IN-LB
1-1/4"	1.00	1.80	3.60	2.80	7.80	0.93	1.50	0.35	1.42	0.76	2.51	52	250 IN-LB
1-1/2"	1.30	2.10	4.10	3.00	7.80	0.93	1.50	0.35	1.42	0.76	3.74	80	300 IN-LB
2"	1.50	2.30	4.60	3.20	7.80	0.93	1.50	0.35	1.42	0.77	5.53	115	320 IN-LB